



SUPERLOK®

High Pressure Fittings

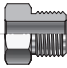
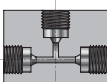
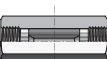

www.superlok.com

| Medium Pressure Fittings | | | | | | | | |
|---|-----------------------------------|------|---|--|------|---|--|------|
|  | SMPG Gland | 217P |  | SMPUC Union Coupling (Slip Type) | 219P |  | SHPE Elbow | 223P |
|  | SMPCR Collar | 218P |  | SMPBC Bulkhead coupling | 219P |  | SHPT Tee | 224P |
|  | SMPP Plug | 218P |  | SMPCP Cap | 220P |  | SHPC Cross | 224P |
|  | SMPE Elbow | 218P |  | SMPN Nipple | 220P |  | SHPSC Straight Coupling | 224P |
|  | SMPT Tee | 218P | High Pressure Fittings | | |  | SHPUC Union Coupling (Slip Type) | 225P |
|  | SMPC Cross | 219P |  | SHPG Gland | 222P |  | SHPBC Bulkhead coupling | 225P |
|  | SMPSC Straight Coupling | 219P |  | SHPCR Collar | 223P |  | SHPCP Cap | 225P |
| | | |  | SHPP Plug | 223P |  | SHPN Nipple | 226P |

Medium Pressure Fittings

SMP Series - 20,000 psi (1380 bar)

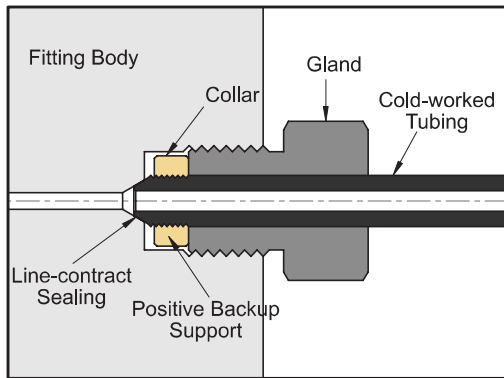

Features

- Pressure to 20,000psi (1380 bar)
- Coned and Threaded connection.
- Available sizes are 1/4" , 3/8" , 9/16" , 3/4" , and 1" .
- Fittings manufactured from cold worked 316 stainless steel.
- Operating temperatures from -423°F (-252°C) to 1200°F (649°C)

Tube Size & End Dimension

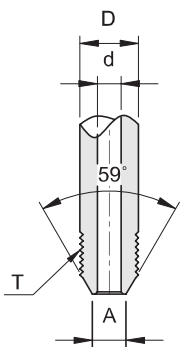

| Tube Size. mm | | | | Flow Area mm ² | Working Pressure. psi | | | | |
|---------------|---------|-------|-----------------|---------------------------|--------------------------------|--------------|---------------|---------------|---------------|
| O.D (D) | I.D (d) | A | Thread (T) | | -325 to 100°F (-198 to 37.8°C) | 200°F (93°C) | 400°F (204°C) | 600°F (316°C) | 800°F (427°C) |
| 1/4" (6.35) | 2.77 | 3.57 | 1/4" - 28 L.H. | 5.81 | 20,000 | 20,000 | 19,250 | 18,050 | 16,800 |
| 3/8" (9.53) | 5.16 | 6.35 | 3/8" - 24 L.H. | 20.65 | 20,000 | 20,000 | 19,250 | 18,050 | 16,800 |
| 9/16" (14.29) | 7.92 | 10.32 | 9/16" - 18 L.H. | 49.03 | 20,000 | 20,000 | 19,250 | 18,050 | 16,800 |
| | 9.12 | | | 65.16 | 15,000 | 15,000 | 14,400 | 13,650 | 12,670 |
| 3/4" (19.05) | 11.13 | 14.29 | 3/4" - 16 L.H. | 97.42 | 20,000 | 20,000 | 19,250 | 18,050 | 16,800 |
| | 13.11 | | | 134.84 | 15,000 | 15,000 | 14,400 | 13,650 | 12,670 |
| 1" (25.40) | 14.27 | 18.26 | 1" - 14 L.H. | 160.00 | 20,000 | 20,000 | 19,250 | 18,050 | 16,800 |
| | 17.48 | | | 239.35 | 15,000 | 15,000 | 14,400 | 13,650 | 12,670 |

SMPG

Gland

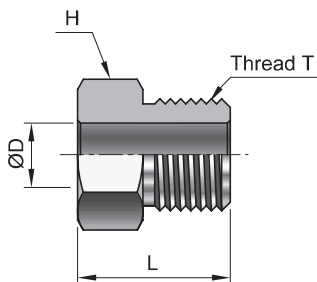

| Part No. | Tube Size (in) | Hex H(in) | D | L | Thread T | Pressure Rating psi |
|----------|----------------|-----------|------|------|-----------------|---------------------|
| SMPG- 4H | 1/4" | 1/2" | 6.4 | 17.5 | 7/16" - 20 UNF | 20,000 |
| SMPG- 6H | 3/8" | 5/8" | 9.5 | 20.6 | 9/16" - 18 UNF | 20,000 |
| SMPG- 9H | 9/16" | 7/8" | 14.3 | 27.0 | 13/16" - 16 UNF | 20,000 |
| SMPG-12H | 3/4" | 1-1/8" | 19.1 | 28.6 | 3/4" - 14 NPSM | 20,000 |
| SMPG-16H | 1" | 1-3/8" | 25.4 | 38.1 | 1-3/8" - 12 UNF | 20,000 |

• All dimensions in millimeters unless specified as "inch". Dimension are for reference only, subject to change.

SMPCR

Collar

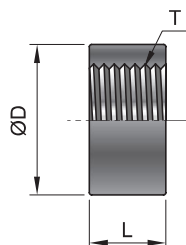

| Part No. | Tube Size (in) | D | L | Thread T | Pressure Rating psi |
|-----------|----------------|------|------|-----------------|---------------------|
| SMPCR- 4H | 1/4" | 9.5 | 5.6 | 1/4" - 28 L.H. | 20,000 |
| SMPCR- 6H | 3/8" | 11.9 | 6.4 | 3/8" - 24 L.H. | 20,000 |
| SMPCR- 9H | 9/16" | 18.3 | 7.9 | 9/16" - 18 L.H. | 20,000 |
| SMPCR-12H | 3/4" | 23.8 | 9.5 | 3/4" - 16 L.H. | 20,000 |
| SMPCR-16H | 1" | 31.8 | 12.7 | 1" - 14 L.H. | 20,000 |

SMPP

Plug

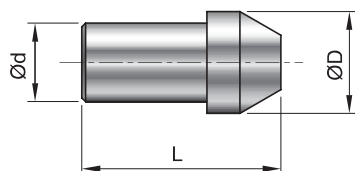

| Part No. | Tube Size (in) | d | D | L | Pressure Rating psi |
|----------|----------------|------|------|------|---------------------|
| SMPP- 4H | 1/4" | 6.4 | 9.5 | 25.4 | 20,000 |
| SMPP- 6H | 3/8" | 9.5 | 11.9 | 31.8 | 20,000 |
| SMPP- 9H | 9/16" | 14.3 | 18.3 | 39.7 | 20,000 |
| SMPP-12H | 3/4" | 19.1 | 23.9 | 44.5 | 20,000 |
| SMPP-16H | 1" | 25.4 | 31.8 | 60.3 | 20,000 |

SMPE

Elbow

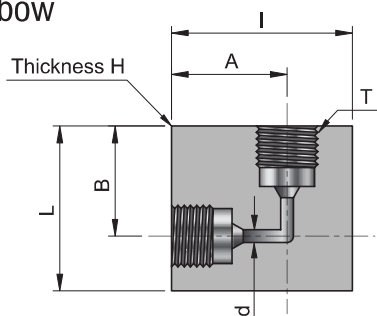

| Part No. | Tube Size (in) | d | A | B | I | L | H | T | Pressure Rating psi |
|-----------|----------------|------|------|------|------|------|------|-----------------|---------------------|
| SMPE - 4H | 1/4" | 3.2 | 22.2 | 17.5 | 30.2 | 25.4 | 15.9 | 7/16" - 20 UNF | 20,000 |
| SMPE - 6H | 3/8" | 5.6 | 25.4 | 25.4 | 34.9 | 34.9 | 19.1 | 9/16" - 18 UNF | 20,000 |
| SMPE - 9H | 9/16" | 9.1 | 31.8 | 31.8 | 44.5 | 44.5 | 25.4 | 13/16" - 16 UNF | 20,000 |
| SMPE -12H | 3/4" | 13.1 | 38.1 | 38.1 | 57.2 | 57.2 | 34.9 | 3/4" - 14 NPSM | 20,000 |
| SMPE -16H | 1" | 17.5 | 52.4 | 52.4 | 76.2 | 76.2 | 44.5 | 1-3/8" - 12 UNF | 20,000 |

SMPT

Tee

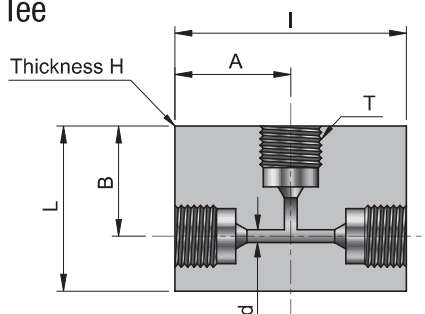

| Part No. | Tube Size (in) | d | A | B | I | L | H | T | Pressure Rating psi |
|-----------|----------------|------|------|------|-------|------|------|-----------------|---------------------|
| SMPT - 4H | 1/4" | 3.2 | 22.2 | 17.5 | 44.5 | 25.4 | 15.9 | 7/16" - 20 UNF | 20,000 |
| SMPT - 6H | 3/8" | 5.6 | 25.4 | 25.4 | 50.8 | 34.9 | 19.1 | 9/16" - 18 UNF | 20,000 |
| SMPT - 9H | 9/16" | 9.1 | 31.8 | 31.8 | 63.5 | 44.5 | 25.4 | 13/16" - 16 UNF | 20,000 |
| SMPT -12H | 3/4" | 13.1 | 38.1 | 38.1 | 76.2 | 57.2 | 34.9 | 3/4" - 14 NPSM | 20,000 |
| SMPT -16H | 1" | 17.5 | 52.4 | 52.4 | 104.8 | 76.2 | 44.5 | 1-3/8" - 12 UNF | 20,000 |

• All dimensions in millimeters unless specified as "inch". Dimension are for reference only, subject to change.

SMPC

Cross

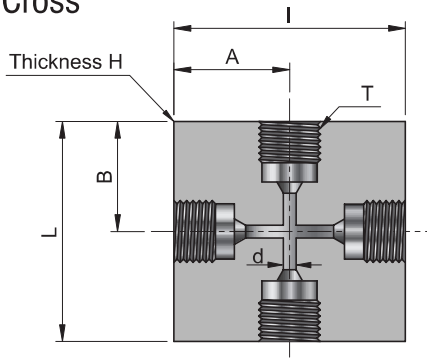

| Part No. | Tube Size (in) | d | A | B | I | L | H | T | Pressure Rating psi |
|-----------|----------------|------|------|------|-------|-------|------|-----------------|---------------------|
| SMPC - 4H | 1/4" | 3.2 | 22.2 | 17.5 | 44.5 | 34.9 | 15.9 | 7/16" - 20 UNF | 20,000 |
| SMPC - 6H | 3/8" | 5.6 | 25.4 | 25.4 | 50.8 | 50.8 | 19.1 | 9/16" - 18 UNF | 20,000 |
| SMPC - 9H | 9/16" | 9.1 | 31.8 | 31.8 | 63.5 | 63.5 | 25.4 | 13/16" - 16 UNF | 20,000 |
| SMPC -12H | 3/4" | 13.1 | 38.1 | 38.1 | 76.2 | 76.2 | 34.9 | 3/4" - 14 NPSM | 20,000 |
| SMPC -16H | 1" | 17.5 | 52.4 | 52.4 | 104.8 | 104.8 | 44.5 | 1-3/8" - 12 UNF | 20,000 |

SMPSC

Straight Coupling

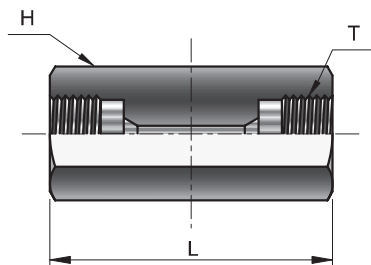

| Part No. | Tube Size (in) | Hex H (in) | Orifice | L | T | Pressure Rating psi |
|------------|----------------|------------|---------|------|-----------------|---------------------|
| SMPSC - 4H | 1/4" | 5/8" | 3.2 | 39.7 | 7/16" - 20 UNF | 20,000 |
| SMPSC - 6H | 3/8" | 3/4" | 5.6 | 44.5 | 9/16" - 18 UNF | 20,000 |
| SMPSC - 9H | 9/16" | 1" | 9.1 | 54.0 | 13/16" - 16 UNF | 20,000 |
| SMPSC -12H | 3/4" | 1 - 3/8" | 13.1 | 63.5 | 3/4" - 14 NPSM | 20,000 |
| SMPSC -16H | 1" | 1 - 3/4" | 17.5 | 88.9 | 1-3/8" - 12 UNF | 20,000 |

SMPUC

Union Coupling (Slip Type)

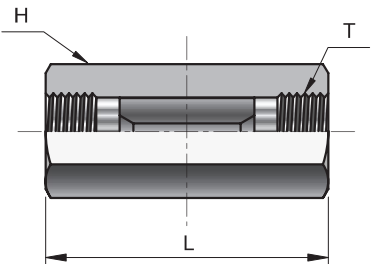

| Part No. | Tube Size (in) | Hex H (in) | Orifice | L | T | Pressure Rating psi |
|------------|----------------|------------|---------|------|-----------------|---------------------|
| SMPUC - 4H | 1/4" | 5/8" | 3.2 | 39.7 | 7/16" - 20 UNF | 20,000 |
| SMPUC - 6H | 3/8" | 3/4" | 5.6 | 44.5 | 9/16" - 18 UNF | 20,000 |
| SMPUC - 9H | 9/16" | 1" | 9.1 | 54.0 | 13/16" - 16 UNF | 20,000 |
| SMPUC -12H | 3/4" | 1 - 3/8" | 13.1 | 63.5 | 3/4" - 14 NPSM | 20,000 |
| SMPUC -16H | 1" | 1 - 3/4" | 17.5 | 88.9 | 1-3/8" - 12 UNF | 20,000 |

SMPBC

Bulkhead Coupling

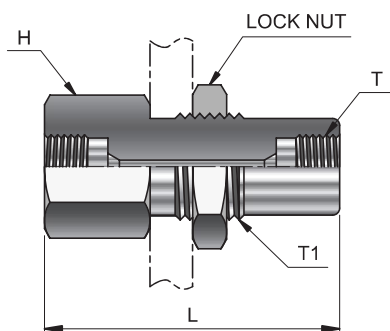

| Part No. | Tube Size (in) | Hex H (in) | Orifice | L | T | T1 | Pressure Rating psi |
|------------|----------------|------------|---------|------|-----------------|------------------|---------------------|
| SMPBC - 4H | 1/4" | 1" | 3.2 | 47.6 | 7/16" - 20 UNF | 3/4" - 16 UNF | 20,000 |
| SMPBC - 6H | 3/8" | 1" | 5.6 | 50.8 | 9/16" - 18 UNF | 7/8" - 14 UNF | 20,000 |
| SMPBC - 9H | 9/16" | 1-3/8" | 9.1 | 60.3 | 13/16" - 16 UNF | 1-1/16" - 12 UNF | 20,000 |
| SMPBC -12H | 3/4" | 1-7/8" | 13.1 | 66.7 | 3/4" - 14 NPSM | 1-5/8" - 12 UNF | 20,000 |
| SMPBC -16H | 1" | 2-1/8" | 17.5 | 88.9 | 1-3/8" - 12 UNF | 1-7/8" - 12 UNF | 20,000 |

• All dimensions in millimeters unless specified as "inch". Dimension are for reference only, subject to change.

SMPCP

Cap

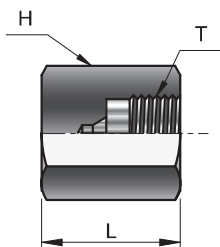

| Part No. | Tube Size (in) | Hex H (in) | L | T | Pressure Rating psi |
|-------------|----------------|------------|------|-----------------|---------------------|
| SMPCP - 4H | 1/4" | 5/8" | 22.2 | 7/16" - 20 UNF | 20,000 |
| SMPCP - 6H | 3/8" | 3/4" | 34.9 | 9/16" - 18 UNF | 20,000 |
| SMPCP - 9H | 9/16" | 1" | 38.1 | 13/16" - 16 UNF | 20,000 |
| SMPCP - 12H | 3/4" | 1 - 3/8" | 63.5 | 3/4" - 14 NPSM | 20,000 |
| SMPCP - 16H | 1" | 1 - 3/4" | 76.2 | 1-3/8" - 12 UNF | 20,000 |

SMPN

Nipple



For rapid system make-up, **SUPERLOK** supplies precut, coned-and-threaded nipples in various sizes and lengths for **SUPERLOK** medium pressure fittings.

Special lengths

In addition to the standard lengths listed in the table below, nipples are available in any custom length. Consult factory.

Materials

Part numbers in table refer to Type 316 Stainless steel. Optional materials available. Consult factory.

| Tube Size In (mm) | | Part No. Nipple Length In (mm) | | | | | | | Working Pressure at 100°F psi |
|----------------------|----------------|-----------------------------------|-----------|------------|--------------|--------------|---------------|---------------|----------------------------------|
| O.D. | I.D. | 2.75" (69.9) | 3" (76.2) | 4" (101.6) | 6" (152.4) | 8" (203.2) | 10" (254) | 12" (304.8) | |
| 1/4" (6.35) | 0.109" (2.77) | SMPN-4-2.75L | SMPN-4-3L | SMPN-4-4L | SMPN-4-6L | SMPN-4-8L | SMPN-4-10L | SMPN-4-12L | 20,000 |
| 3/8" (9.53) | 0.203" (5.16) | | SMPN-6-3L | SMPN-6-4L | SMPN-6-6L | SMPN-6-8L | SMPN-6-10L | SMPN-6-12L | 20,000 |
| 9/16" (14.29) | 0.312" (7.92) | | | SMPN-9-4L | SMPN-9-6L | SMPN-9-8L | SMPN-9-10L | SMPN-9-12L | 20,000 |
| 3/4" (19.05) | 0.438" (11.13) | | | | SMPN-12-6L | SMPN-12-8L | SMPN-12-10L | SMPN-12-12L | 20,000 |
| | 0.515" (13.09) | | | | SMPN10-12-6L | SMPN10-12-8L | SMPN10-12-10L | SMPN10-12-12L | 10,000 |
| 1" (25.4) | 0.562" (14.27) | | | | SMPN-16-6L | SMPN-16-8L | SMPN-16-10L | SMPN-16-12L | 20,000 |
| | 0.687" (17.45) | | | | SMPN10-16-6L | SMPN10-16-8L | SMPN10-16-10L | SMPN10-16-12L | 10,000 |

• All dimensions in millimeters unless specified as "inch". Dimension are for reference only, subject to change.

Anti - Vibration Collet Gland - Pressure to 20,000psi

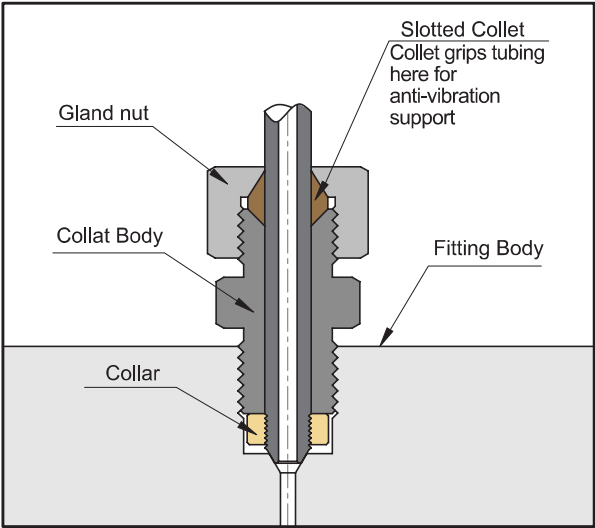

anti-vibration collet galnd assembly strengthens the entire structure. With stress concentrntation reduced and overall stress level maintained well below the endurance limit of the material, the result is virtually unlimited vibrational fatigue life.

For extreme conditions of vibration and(or) shock in tubing systems, such as an unsupported line near a compressor, coned and threaded connections are offered with the **SUPERLOK** anti-vibration collet gland assembly.

Completely interchangeable with standard **SUPERLOK** medium pressure connections, the collet gland assembly provides equally effective pressure handling capability. In standard connection systems, the bending stresses on the threaded area of the tubing imposed by excessive vibration or movement may cause premature fatigue failure of the tubing at the back of the thread. By moving the stress concentration back to the unthreaded part of the tubing and providing a wedge-type gripping action, the **SUPERLOK**

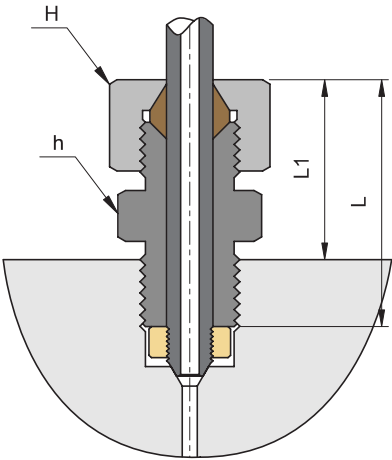

| Part No. | Tube Size (in) | Hex H (in) | | L1 | L | Collar |
|--------------|----------------|------------|----------|------|------|----------|
| | | h | H | | | |
| SMP-AVCG- 4H | 1/4" | 1/2" | 5/8" | 23.9 | 30.2 | SMPCR- 4 |
| SMP-AVCG- 6H | 3/8" | 5/8" | 3/4" | 30.2 | 38.1 | SMPCR- 6 |
| SMP-AVCG- 9H | 9/16" | 7/8" | 7/8" | 35.8 | 45.2 | SMPCR- 9 |
| SMP-AVCG-12H | 3/4" | 1 - 1/8" | 1 - 1/8" | 40.4 | 50.8 | SMPCR-12 |
| SMP-AVCG-16H | 1" | 1 - 3/8" | 1 - 3/8" | 42.9 | 60.5 | SMPCR-16 |

• All dimensions in millimeters unless specified as "inch". Dimension are for reference only, subject to change.

High Pressure Fittings

SHP Series - 60,000 psi (4137 bar)

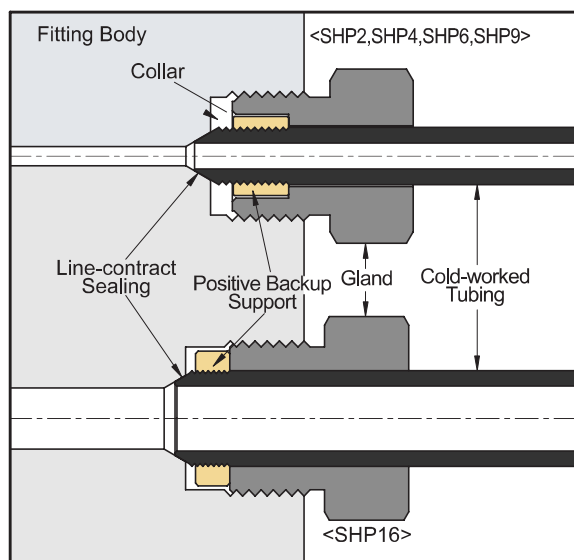

Features

- Pressure to 60,000 psi (4137 bar)
- Increased pressure handling capabilities.
- Coned and Threaded connection.
- Available sizes are 1/8" , 1/4" , 3/8" , 9/16" and 1" .
- Fittings manufactured from cold worked 316 stainless steel.
- Operating temperatures from -423°F (-252°C) to 1200°F (649°C)
- Anti-vibration connection components available.

Tube Size & end Dimension

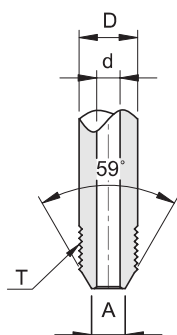

| Tube Size mm | | | | Flow Area mm ² | Working Pressure psi | | | | |
|------------------|-----------|-------|-----------------|---------------------------------|-----------------------------------|-----------------|------------------|------------------|------------------|
| O.D (D) | LD (d) | A | Thread (T) | | -325 to 100°F (-198 to 37.8°C) | 200°F (93°C) | 400°F (204°C) | 600°F (316°C) | 800°F (427°C) |
| 1/8"(3.18) | 0.51 | 1.59 | 1/8"- 40 L.H. | 0.203 | 60,000 | 60,000 | 57,750 | 54,250 | 50,700 |
| 1/4"(6.35) | 2.77 | 3.18 | 1/4"- 28 L.H. | 3.23 | 60,000 | 60,000 | 57,750 | 54,250 | 50,700 |
| 3/8"(9.53) | 5.16 | 5.56 | 3/8"- 24 L.H. | 7.74 | 60,000 | 60,000 | 57,750 | 54,250 | 50,700 |
| 9/16" (14.29) | 4.78 | 7.14 | 9/16" - 18 L.H. | 18.06 | 60,000 | 60,000 | 57,750 | 54,250 | 50,700 |
| | 6.35 | | | 30.97 | 40,000 | 40,000 | 38,500 | 36,100 | 33,800 |
| 1"(25.40) | 11.13 | 14.29 | 1" - 14 L.H. | 97.42 | 43,000 | 43,000 | 43,000 | 41,380 | 36,330 |

SHPG

Gland

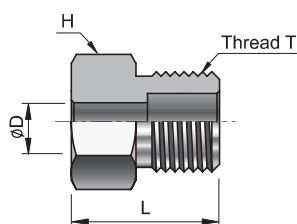

| Part No. | Tube Size (in) | Hex H (in) | D | L | T | Pressure Rating psi |
|--------------|-------------------|---------------|------|------|-----------------|------------------------|
| SHPG - 2H | 1/8" | 1/2" | 3.2 | 19.1 | 1/2" - 20 UNF | 60,000 |
| SHPG - 4H | 1/4" | 5/8" | 6.4 | 20.6 | 9/16" - 18 UNF | 60,000 |
| SHPG - 6H | 3/8" | 13/16" | 9.5 | 23.8 | 3/4" - 16 UNF | 60,000 |
| SHPG - 9H | 9/16" | 1-3/16" | 14.3 | 34.9 | 1-1/8" - 12 UNF | 60,000 |
| SHPG40 - 9H | 9/16" | 1-3/16" | 14.3 | 34.9 | 1-1/8" - 12 UNF | 40,000 |
| SHPG30 - 16H | 1" | 1-3/8" | 25.4 | 38.1 | 1-3/8" - 12 UNF | 30,000 |

• All dimensions in millimeters unless specified as "inch". Dimension are for reference only, subject to change.

SHPCR

Collar

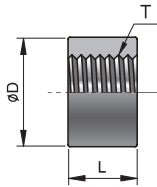

| Part No. | Tube Size (in) | D | L | Thread T | Pressure Rating psi |
|---------------|----------------|------|------|-----------------|---------------------|
| SHPCR - 2H | 1/8" | 6.4 | 7.9 | 1/8" - 40 L.H. | 60,000 |
| SHPCR - 4H | 1/4" | 9.5 | 9.5 | 1/4" - 28 L.H. | 60,000 |
| SHPCR - 6H | 3/8" | 12.7 | 13.5 | 3/8" - 24 L.H. | 60,000 |
| SHPCR - 9H | 9/16" | 20.6 | 15.9 | 9/16" - 18 L.H. | 60,000 |
| SHPCR40 - 9H | 9/16" | 20.6 | 15.9 | 3/4" - 16 L.H. | 40,000 |
| SHPCR30 - 16H | 1" | 31.8 | 12.7 | 1" - 14 L.H. | 30,000 |

SHPP

Plug

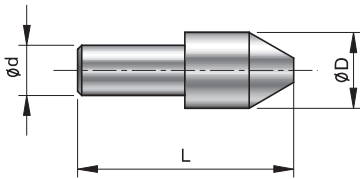

| Part No. | Tube Size (in) | d | D | L | Pressure Rating psi |
|-----------|----------------|------|------|------|---------------------|
| SHPP - 2H | 1/8" | 3.2 | 6.4 | 22.2 | 60,000 |
| SHPP - 4H | 1/4" | 6.4 | 9.5 | 28.6 | 60,000 |
| SHPP - 6H | 3/8" | 9.5 | 12.7 | 33.3 | 60,000 |
| SHPP - 9H | 9/16" | 14.3 | 20.6 | 44.5 | 60,000 |

SHPE

Elbow

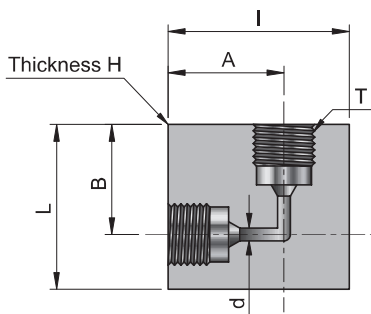

| Part No. | Tube Size (in) | d | A | B | I | L | H | T | Pressure Rating psi |
|--------------|----------------|------|------|------|------|------|------|-----------------|---------------------|
| SHPE - 2H | 1/8" | 1.2 | 19.1 | 19.1 | 28.6 | 28.6 | 19.1 | 1/2" - 20 UNF | 60,000 |
| SHPE - 4H | 1/4" | 2.4 | 22.2 | 25.4 | 34.9 | 38.1 | 25.4 | 9/16" - 18 UNF | 60,000 |
| SHPE - 6H | 3/8" | 4.8 | 31.8 | 25.4 | 44.5 | 38.1 | 25.4 | 3/4" - 16 UNF | 60,000 |
| SHPE - 9H | 9/16" | 6.4 | 47.6 | 28.6 | 66.7 | 47.6 | 38.1 | 1-1/8" - 12 UNF | 60,000 |
| SHPE40 - 9H | 9/16" | 6.4 | 47.6 | 28.6 | 66.7 | 47.6 | 38.1 | 1-1/8" - 12 UNF | 40,000 |
| SHPE30 - 16H | 1" | 11.1 | 52.4 | 52.4 | 76.2 | 76.2 | 44.5 | 1-3/8" - 12 UNF | 30,000 |

SHPT

Tee

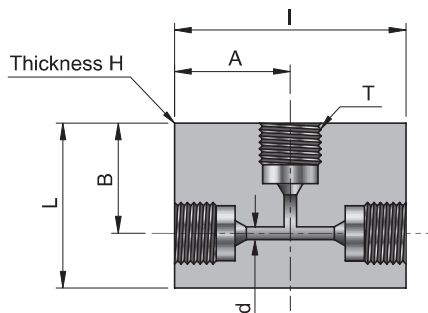

| Part No. | Tube Size (in) | d | A | B | I | L | H | T | Pressure Rating psi |
|-------------|----------------|------|------|------|-------|------|------|-----------------|---------------------|
| SHPT - 2H | 1/8" | 1.2 | 19.1 | 17.5 | 38.1 | 28.6 | 19.1 | 1/2" - 20 UNF | 60,000 |
| SHPT - 4H | 1/4" | 2.4 | 25.4 | 25.4 | 50.8 | 34.9 | 25.4 | 9/16" - 18 UNF | 60,000 |
| SHPT - 6H | 3/8" | 4.8 | 25.4 | 31.8 | 50.8 | 39.7 | 25.4 | 3/4" - 16 UNF | 60,000 |
| SHPT - 9H | 9/16" | 6.4 | 33.3 | 34.9 | 66.7 | 54.0 | 38.1 | 1-1/8" - 12 UNF | 60,000 |
| SHPT40 - 9H | 9/16" | 6.4 | 33.3 | 34.9 | 66.7 | 54.0 | 38.1 | 1-1/8" - 12 UNF | 40,000 |
| SHPT30 -16H | 1" | 11.1 | 52.4 | 52.4 | 104.8 | 76.2 | 44.5 | 1-3/8" - 12 UNF | 30,000 |

SHPC

Cross

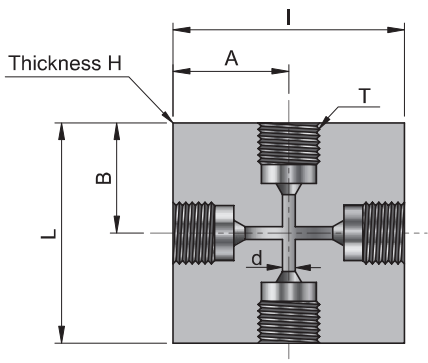

| Part No. | Tube Size (in) | d | A | B | I | L | H | T | Pressure Rating psi |
|-------------|----------------|------|------|------|-------|-------|------|-----------------|---------------------|
| SHPC - 2H | 1/8" | 1.2 | 19.1 | 19.1 | 38.1 | 38.1 | 19.1 | 1/2" - 20 UNF | 60,000 |
| SHPC - 4H | 1/4" | 2.4 | 25.4 | 19.1 | 50.8 | 38.1 | 25.4 | 9/16" - 18 UNF | 60,000 |
| SHPC - 6H | 3/8" | 4.8 | 27.0 | 25.4 | 54.0 | 50.8 | 25.4 | 3/4" - 16 UNF | 60,000 |
| SHPC - 9H | 9/16" | 6.4 | 34.9 | 33.3 | 69.9 | 66.7 | 38.1 | 1-1/8" - 12 UNF | 60,000 |
| SHPC40 - 9H | 9/16" | 6.4 | 34.9 | 33.3 | 69.9 | 66.7 | 38.1 | 1-1/8" - 12 UNF | 40,000 |
| SHPC30 -16H | 1" | 11.1 | 52.4 | 52.4 | 104.8 | 104.8 | 44.5 | 1-3/8" - 12 UNF | 30,000 |

SHPSC

Straight Coupling

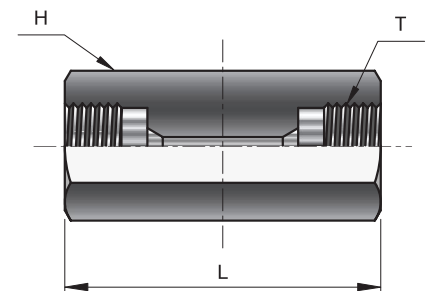

| Part No. | Tube Size (in) | Hex H (in) | Orifice | L | T | Pressure Rating psi |
|--------------|----------------|------------|---------|------|-----------------|---------------------|
| SHPSC - 2H | 1/8" | 3/4" | 1.2 | 28.6 | 1/2" - 20 UNF | 60,000 |
| SHPSC - 4H | 1/4" | 1" | 2.4 | 44.5 | 9/16" - 18 UNF | 60,000 |
| SHPSC - 6H | 3/8" | 1" | 4.8 | 50.8 | 3/4" - 16 UNF | 60,000 |
| SHPSC - 9H | 9/16" | 1 - 3/8" | 6.4 | 60.3 | 1-1/8" - 12 UNF | 60,000 |
| SHPSC40 - 9H | 9/16" | 1 - 3/8" | 6.4 | 60.3 | 1-1/8" - 12 UNF | 40,000 |
| SHPSC30 -16H | 1" | 1 - 3/4" | 11.1 | 88.9 | 1-3/8" - 12 UNF | 30,000 |

• All dimensions in millimeters unless specified as "inch". Dimension are for reference only, subject to change.

SHPUC

Union Coupling (Slip Type)

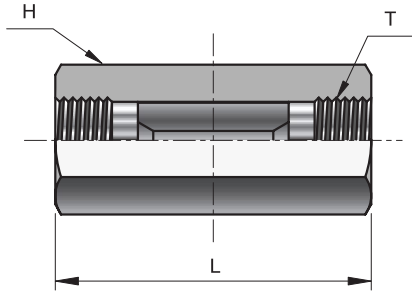

| Part No. | Tube Size (in) | Hex H (in) | Orifice | L | T | Pressure Rating psi |
|--------------|----------------|------------|---------|------|-----------------|---------------------|
| SHPUC - 2H | 1/8" | 3/4" | 1.2 | 28.6 | 1/2" - 20 UNF | 60,000 |
| SHPUC - 4H | 1/4" | 1" | 2.4 | 44.5 | 9/16" - 18 UNF | 60,000 |
| SHPUC - 6H | 3/8" | 1" | 4.8 | 50.8 | 3/4" - 16 UNF | 60,000 |
| SHPUC - 9H | 9/16" | 1 - 3/8" | 6.4 | 60.3 | 1-1/8" - 12 UNF | 60,000 |
| SHPUC40 - 9H | 9/16" | 1 - 3/8" | 6.4 | 60.3 | 1-1/8" - 12 UNF | 40,000 |
| SHPUC30 -16H | 1" | 1 - 3/4" | 11.1 | 88.9 | 1-3/8" - 12 UNF | 30,000 |

SHPBC

Bulkhead Coupling

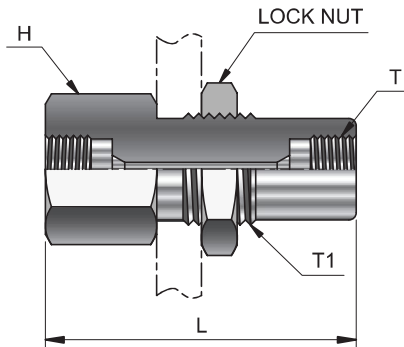

| Part No. | Tube Size (in) | Hex H (in) | Orifice | L | T | T1 | Pressure Rating psi |
|--------------|----------------|------------|---------|------|-----------------|------------------|---------------------|
| SHPBC - 2H | 1/8" | 1" | 1.2 | 46.0 | 1/2" - 20 UNF | 7/8" - 14 UNF | 60,000 |
| SHPBC - 4H | 1/4" | 1" | 2.4 | 50.8 | 9/16" - 18 UNF | 7/8" - 14 UNF | 60,000 |
| SHPBC - 6H | 3/8" | 1-3/8" | 4.8 | 60.3 | 3/4" - 16 UNF | 1-1/16" - 12 UNF | 60,000 |
| SHPBC - 9H | 9/16" | 1-7/8" | 6.4 | 69.9 | 1-1/8" - 12 UNF | 1-5/8" - 12 UNF | 60,000 |
| SHPBC40 - 9H | 9/16" | 1-7/8" | 6.4 | 69.9 | 1-1/8" - 12 UNF | 1-5/8" - 12 UNF | 40,000 |
| SHPBC30 -16H | 1" | 1-7/8" | 11.1 | 88.9 | 1-3/8" - 12 UNF | 2-1/8" - 12 UNF | 30,000 |

SHPCP

Cap

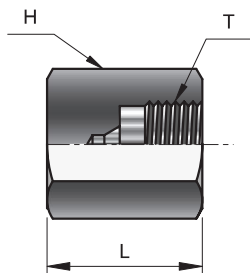

| Part No. | Tube Size (in) | Hex H (in) | L | T | Pressure Rating psi |
|--------------|----------------|------------|------|-----------------|---------------------|
| SHPCP - 2H | 1/8" | 3/4" | 22.2 | 1/2" - 20 UNF | 60,000 |
| SHPCP - 4H | 1/4" | 3/4" | 22.2 | 9/16" - 18 UNF | 60,000 |
| SHPCP - 6H | 3/8" | 1" | 31.8 | 3/4" - 16 UNF | 60,000 |
| SHPCP - 9H | 9/16" | 1 - 3/8" | 38.1 | 1-1/8" - 12 UNF | 60,000 |
| SHPCP40 - 9H | 9/16" | 1 - 3/8" | 38.1 | 1-1/8" - 12 UNF | 40,000 |
| SHPCP30 -16H | 1" | 1 - 3/4" | 76.2 | 1-3/8" - 12 UNF | 30,000 |

SHPN

Nipple



For rapid system make-up, **SUPERLOK®** supplies precut, coned-and-threaded nipples in various sizes and lengths for **SUPERLOK®** high pressure fittings.

Special lengths

In addition to the standard lengths listed in the table below, nipples are available in any custom length. Consult factory.

Materials

Part numbers in table refer to Type 316 Stainless steel. Optional materials available. Consult factory.

| Tube Size In (mm) | | Part No. Nipple Length In (mm) | | | | | | | Working Pressure at 100°F psi |
|----------------------|----------------|-----------------------------------|-----------|-------------|--------------|--------------|---------------|---------------|-------------------------------------|
| O.D. | I.D. | 2.75" (69.9) | 3" (76.2) | 4" (101.6) | 6" (152.4) | 8" (203.2) | 10" (254) | 12" (304.8) | |
| 1/8" (3.18) | 0.020" (0.51) | SHPN-4-2.75L | SHPN-2-3L | SHPN-2-4L | SHPN-2-6L | SHPN-2-8L | SHPN-2-10L | SHPN-2-12L | 60,000 |
| 1/4" (6.35) | 0.083" (2.11) | SHPN-4-2.75L | SHPN-4-3L | SHPN-4-4L | SHPN-4-6L | SHPN-4-8L | SHPN-4-10L | SHPN-4-12L | 60,000 |
| 3/8" (9.53) | 0.125" (3.18) | | SHPN-6-3L | SHPN-6-4L | SHPN-6-6L | SHPN-6-8L | SHPN-6-10L | SHPN-6-12L | 60,000 |
| 9/16" (14.29) | 0.188" (4.78) | | | SHPN-9-4L | SHPN-9-6L | SHPN-9-8L | SHPN-9-10L | SHPN-9-12L | 60,000 |
| | 0.250" (6.35) | | | SHPN40-9-4L | SHPN40-9-6L | SHPN40-9-8L | SHPN40-9-10L | SHPN40-9-12L | 40,000 |
| 1" (25.4) | 0.437" (11.09) | | | | SHPN30-16-6L | SHPN30-16-8L | SHPN30-16-10L | SHPN30-16-12L | 30,000 |

• All dimensions in millimeters unless specified as "inch". Dimension are for reference only, subject to change.

Anti - Vibration Collet Gland - Pressure to 60,000psi

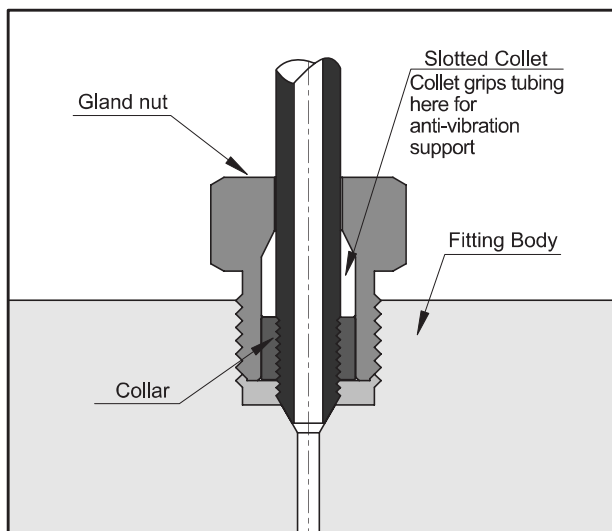

For extreme conditions of vibration and(or) shock in tubing system, such as locating fitting on an unsupported line near a compressor, SUPERLOK coned and threaded connections are offered with the anti-vibration collet gland assemblies. Completely interchangeable with standard SUPERLOK high pressure connections, the collet gland assemblies provide equally effective pressure handling capability.

In standard connection systems, the bending stresses on the threaded area of the tubing imposed by excessive vibration or movement may cause premature fatigue failure of the tubing at the back of the thread. By moving the stress concentration back to the unthreaded part of the tubing and

providing a wedge-type gripping action, the **SUPERLOK[®]** anti-vibration collet gland assembly strengthens the entire structure. With stress concentration reduced and overall stress level maintained well below the endurance limit of the material, the result is virtually unlimited vibrational fatigue life.

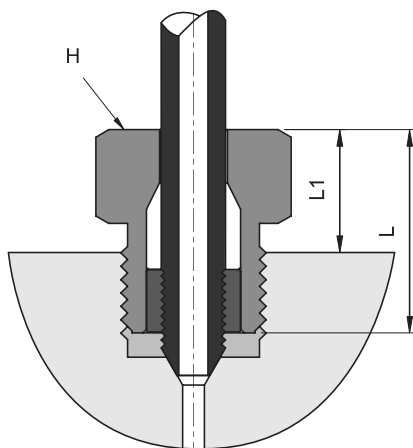

| Part No. | Tube Size (in) | Hex H (in) | L1 | L |
|---------------|----------------|------------|------|------|
| SHP- AVCG- 4H | 1/4" | 5/8" | 12.7 | 20.6 |
| SHP- AVCG- 6H | 3/8" | 7/8" | 15.8 | 28.5 |
| SHP- AVCG- 9H | 9/16" | 1 - 3/16" | 25.4 | 30.2 |

• All dimensions in millimeters unless specified as "inch". Dimension are for reference only, subject to change.

Anti - Vibration Collet Gland - Pressure to 43,000psi (size to 1")

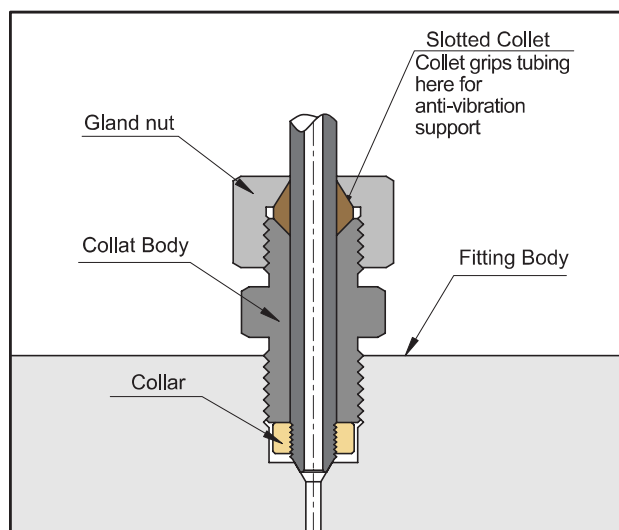

For extreme conditions of vibration and(or) shock in tubing system, such as locating fitting on an unsupported line near a compressor, **SUPERLOK®** coned and threaded connections are offered with the anti-vibration collet gland assemblies.

A less complex and more economical design than other vibration-resistant connections, the collet gland assembly utilizes the same coned and threaded features of SUPERLOK high pressure connections.

Series SHP - AVCG -16 extend the gland nut to provide room for the tapered, slotted collet and collet nut. The design provides a slight difference in angles between the collet and the corresponding taper of the gland nut. As the nut is tightened,

it acts to wedge the tapered end of the collet into a gripping engagement with the tubing.

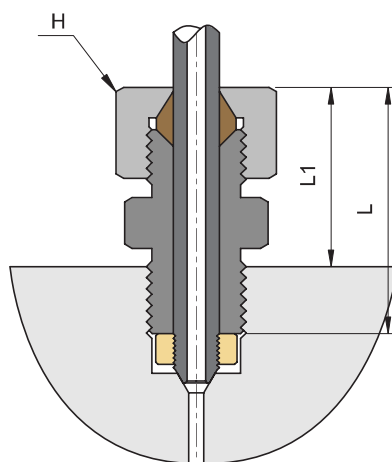

| Part No. | Tube Size (in) | Hex H (in) | L1 | L |
|----------------|----------------|------------|------|------|
| SHP- AVCG- 16H | 1" | 1 - 1/2" | 42.9 | 60.5 |

• All dimensions in millimeters unless specified as "inch". Dimension are for reference only, subject to change.

Installation Instructions

Medium Pressure and High Pressure Coned and Threaded Tube Connections

1. Apply a process-compatible lubricant to the gland threads.
2. Slip the gland onto the tube, then thread the collar onto the tube end.
3. A small amount of process-compatible lubricant applied to the tube cone will facilitate sealing. Insert the tubing into the connection and tighten finger tight.
4. Tighten gland slightly with the wrench.

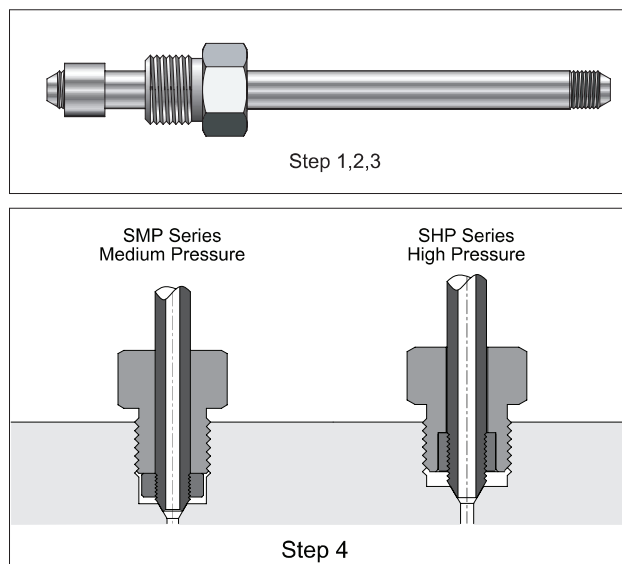

Ordering Information

Example :

SMP G - 8H - SS

1 2 3 4

1. Pressure of Fitting

SMP : Medium Pressure Fitting

SHP : High Pressure Fitting

2. Type of Fitting - Refer to catalogue Index

G : Gland

E : Elbow

UC : Union Coupling

CR : Collar

T : Tee C : Cross

BC : Bulkhead Coupling

P : Plug

SC : Straight Coupling

CP : Cap

N : Nipple

3. Size of Fitting (Tube O.D)

| Fractional Tube | O.D (inch) | 1/4 | 3/8 | 9/16 | 3/4 | 1 |
|-----------------|-------------|-----|-----|------|-----|-----|
| | Designation | 4H | 6H | 9H | 12H | 16H |

4. Material

SS : A479 TP316



High Pressure Fittings