

Jensen

A Swagelok® Company

Multi-Outlet Tee Fitting



Features

- Main line sizes range from 1 to 4 in. OD; tube butt weld, Kwik-Clamp, and Swagelok® TS series sanitary fitting ends are available.
- 2, 4, or 6 branch ports (1/2 in. OD) are available with tube butt weld, Kwik-Clamp, Swagelok TS sanitary fitting, male NPT thread, or female NPT thread ends. (Fitting with 2 branch ports is available with female NPT thread ends only.)
- Fitting is manufactured from 316L stainless steel.
- Surface finishes meet SFF1 BPE classification; additionally, the OD is polished to 32 µin. R_a .
- Design improves drainability, enhances cleanability, and provides easy assembly.
- Compact design reduces system footprint.

Technical Data

Surface Finish: Every multi-outlet tee is polished to 20 µin. R_a ID (comparable to SFF1 ASME BPE spec) and 32 µin. R_a OD.

Maximum Pressure Rating: 200 psig (13 bar) at 70°F (21°C). The pressure rating of these fittings may be limited by end connection, including the gasket material and clamp used.

Dimensions

Dimensions, in inches (millimeters), are for reference only, and are subject to change.

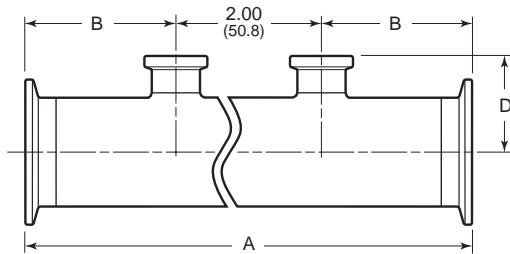

End Connection		Designator
Tube butt weld		BW
Kwik-Clamp		KC
Swagelok TS series sanitary fitting		TS
Female NPT thread		FNPT
Male NPT thread		MNPT

Main Line OD in.	Number of Ports	Dimensions, in. (mm)		
		A	B	D
1	2	7 1/4 (184.1)	2 5/8 (66.7)	1 1/8 (28.6)
	4	11 1/4 (285.7)		
	6	15 1/4 (387.3)		
1 1/2	2	7 3/4 (196.8)	2 7/8 (73.0)	1 3/8 (34.9)
	4	11 3/4 (298.4)		
	6	15 3/4 (400.0)		
2	2	8 3/4 (222.2)	3 3/8 (85.7)	1 5/8 (41.3)
	4	12 3/4 (323.8)		
	6	16 3/4 (425.4)		
2 1/2	2	9 1/4 (234.9)	3 5/8 (92.1)	1 7/8 (47.6)
	4	13 1/4 (336.5)		
	6	17 1/4 (438.1)		
3	2	9 3/4 (247.65)	3 7/8 (98.4)	2 1/8 (54.0)
	4	13 3/4 (349.25)		
	6	17 3/4 (450.8)		
4	2	11 1/2 (292.1)	4 3/4 (120.7)	2 5/8 (66.7)
	4	15 1/2 (393.7)		
	6	19 1/2 (495.3)		

Ordering Information

Create a multi-outlet tee ordering number by adding the designators as shown below.

MOT – 6 – 4 – 30 BW – 50 TS – PL

Product Function
MOT = Multi Outlet Tee

Material Type
6 = 316L stainless steel

Number of Outlets
2 = two (available with FNPT branches only)
4 = four
6 = six

Size of Main Run
10 = 1 in.
15 = 1 1/2 in.
20 = 2 in.
25 = 2 1/2 in.
30 = 3 in.
40 = 4 in.

End Connections for the Main Run
BW = Tube butt weld
KC = Kwik-Clamp
TS = Swagelok TS series sanitary fitting

Surface Finish
PL = 20 µin. R_a ID
32 µin. R_a OD

End Connections for Branches
BW = Tube butt weld
KC = Kwik-Clamp
TS = Swagelok TS series sanitary fitting
FNPT = Female NPT thread
MNPT = Male NPT thread

Size of Branches
50 = 1/2 in.

Safe Product Selection

When selecting a product, the total system design must be considered to ensure safe, trouble-free performance. Function, material compatibility, adequate ratings, proper installation, operation, and maintenance are the responsibilities of the system designer and user.

Caution: Do not mix or interchange parts with those of